

WALL INTERSECTIONS

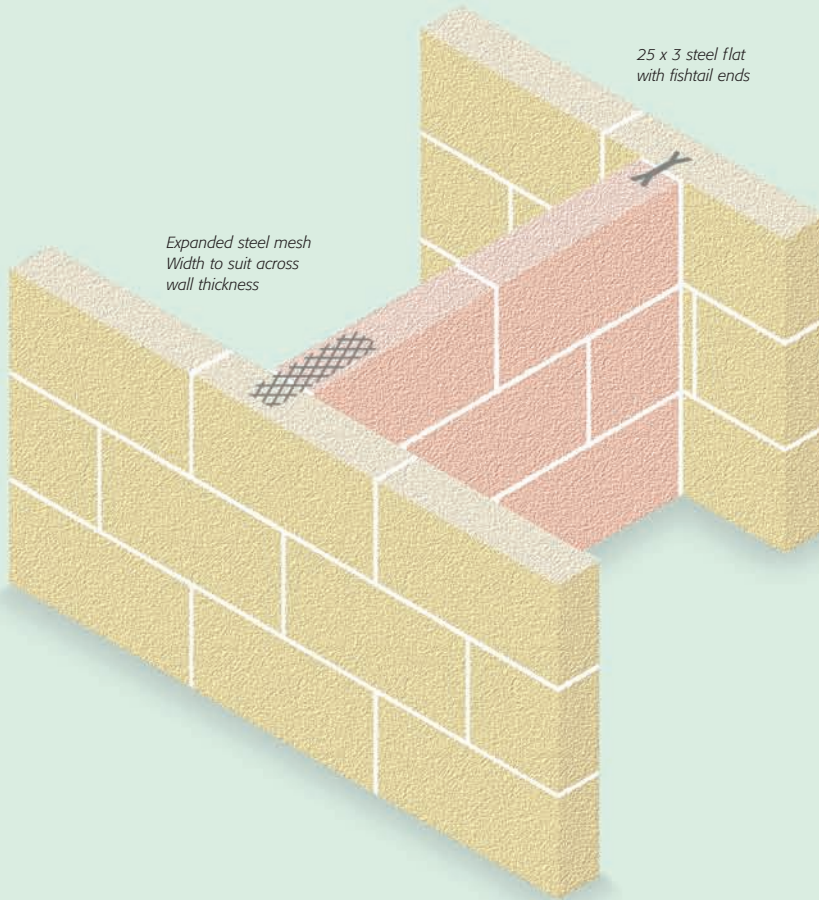

To maintain an unbroken bond pattern on the longitudinal wall panels construct cross-walls with continuous vertical butt joints. Mesh type fixings are adequate for situations without substantial transverse loading for which the fishtail type or suitable proprietary tie would be appropriate.

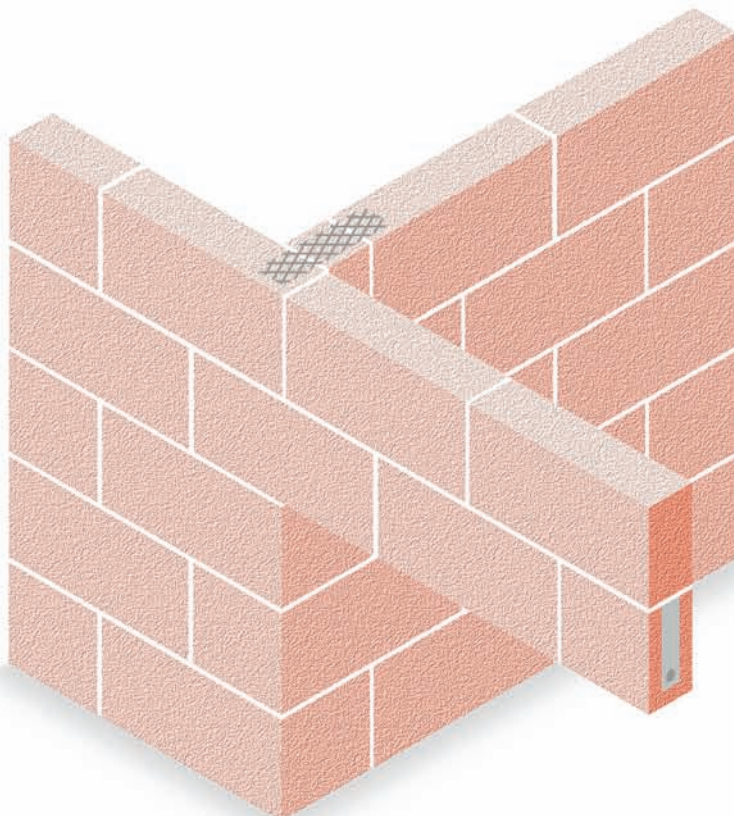

Architectural Masonry Quoin and Lintel blocks may be used to good effect at the intersection of two equally important routes. Below the lintel, the quoin blocks maintain the bond pattern and allow spread of vertical loading. Above the lintel, the return wall may be treated as the cross wall as shown on the drawings.

Steel fixings may be stainless or galvanised carbon steel depending on wall exposure level.

Guidance on exposure situation and durability selection may be taken from BS 5628: Part 3 Clause 5.6.7 or BS 5628: Part 2 Clause 10.1.