

The **PLASKERB** range of KERBS and ACCESSORIES has been specifically designed to give that distinctive edge to your driveway, path or patio. Edging not only looks good but it is essential to prevent the escape of the laying course material from beneath the paving. Laid along the perimeter of a paved area, **PLASKERB** units also help to support traffic loads. They contain lateral movement and prevent rotation of the blocks under load.



You should discuss the following areas of detail with your paving contractor and these need to be agreed, planned into the design and included in the estimate:-

- KERBS AND OTHER FORMS OF EDGE RESTRAINT
- DRAINAGE CHANNELS
- MANHOLES

EDGE RESTRAINTS FOR PATHS AND DRIVEWAYS USING PLASKERB AND PLASPAVE BLOCKS

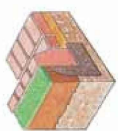

Edging with Plaskerb



Edging with Weathered Plaskerb



Edging with Como Cobblestones



Edging with a double block string course



Edging with a block soldier course

PLASKERB EDGE RESTRAINTS

The **PLASKERB** range comprises of **LARGE and SMALL KERBS, WEATHERED PLASKERBS**, a range of special **RADIAL KERBS** and **SUPPLEMENTARY** units suitable for a variety of applications - see page 63. Plaskerb units are produced in two colours: Brindle and Charcoal, with the Weathered Kerb available in Granite Stone and Peakstone.

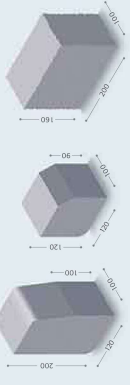

WEATHERED PLASKERB WTRPK*

SMALL KERB SMAPK**

LARGE KERB LGEFK**

COLOUR SPECIFICATION KEY ** BRINDLE BL • CHARCOAL CL * GRANITE STONE GS • PEAKSTONE PS

DIMENSIONS	LARGE KERB	SMALL KERB
Size (mm)	200 x 120 x 100	120 x 120 x 100
PACK INFORMATION		
Linear metres	14.4	21.6 / 25.2*
Pack weight (kg)	720	670 / 782*

WEATHERED KERB	
Size (mm)	200 x 160 x 100
PACK INFORMATION	
Leaf	160mm wide
Laid	180mm wide
Linear metres	28.0
Pack weight (kg)	22.4
	14.0

PLASKERB SHOULD BE ORDERED PER LINEAR METRE IN FULL PACKS *WESTERN DIVISION

PLASKERB SHOULD BE ORDERED PER LINEAR METRE IN FULL PACKS *WESTERN DIVISION

VERSATILE PLASKERB UNITS TO SUIT A RANGE OF APPLICATIONS

** COLOUR SPECIFICATION KEY BRINDLE BL • CHARCOAL CL

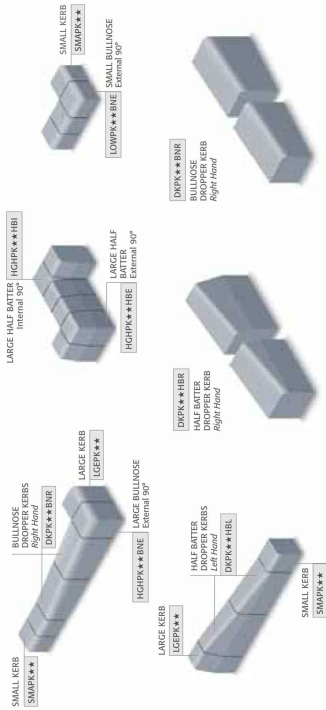

• Example 1

• Example 2

MANHOLES

Plaspave laid in a stretcher or soldier course can be used to make a feature of unsightly ironwork such as manholes. Where the manhole cover has straight sides, blocks can be laid in a stretcher course and butted up against the unit. Alternatively, a recessed manhole cover can be incorporated into the laying pattern as shown here.

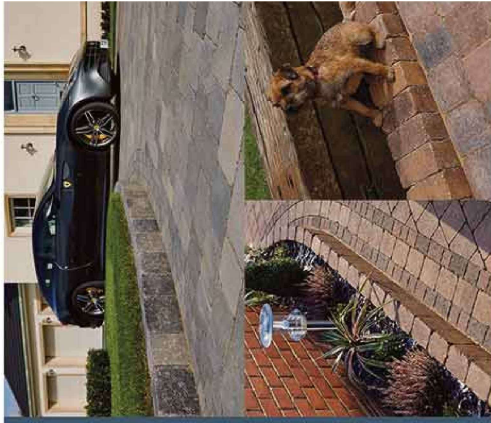
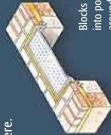

PLASMOBILITY Kerb 99

Available in Charcoal, the Plasmobility Kerb 99 range has been designed in accordance with disabled access guidelines and it is recommended that these kerbs are used in conjunction with Plaseline.

PLASLINE

Plaseline is appropriate for all surface areas subject to traffic by vehicles, wheelchairs, pushchairs. The minimal nature of the chamfer virtually eliminates the uncomfortable vibration and bumping associated with full chamfer paving. Maintenance is reduced as grass growth is minimised.

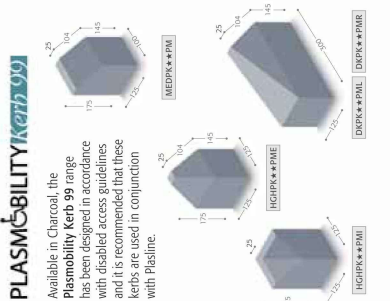

COMO CIRCLE STARTER SET

The Starter Set is ideal for use as the centre block of a Como Circle feature.

